



**WA MUSEUM
HOSPITALITY &
VENUE HIRE**

WESTERN AUSTRALIAN MARITIME MUSEUM

MARITIME MUSEUM BOARDROOM



Spectacular harbour views in a luxurious setting make the Maritime Museum Boardroom an impressive venue for executive and corporate meetings, strategic planning days and workshops.

With glass walls providing uninterrupted views of the waterfront, Maritime Museum Boardroom is an ideal setting for creative planning days whilst showcasing Western Australia's maritime panorama to your colleagues.

TECHNICAL FACILITIES INCLUDE

- 80" Full High Definition flat panel display.
- A hardwired laptop connection point catering to VGA, Audio & HDMI connectivity.
- Blu-Ray player to allow for viewing of Blu-Ray and DVD video (includes DVD upscaling), as well as audio via CD or MP3CD.
- Electronic whiteboard.

CAPACITY

Seats

16

INFORMATION AND BOOKINGS

Telephone: (08) 9431 8323
venuehire@museum.wa.gov.au



FIRST FLOOR

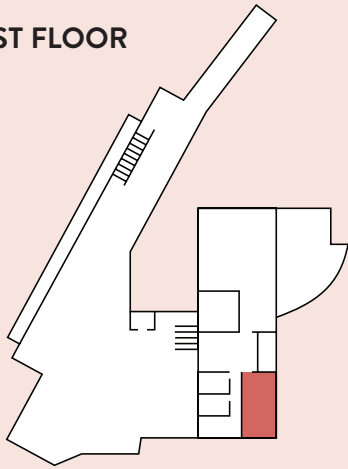

DIMENSIONS

Area **58m²**

DVD/VIDEO PLASMA
SCREEN TV

5300

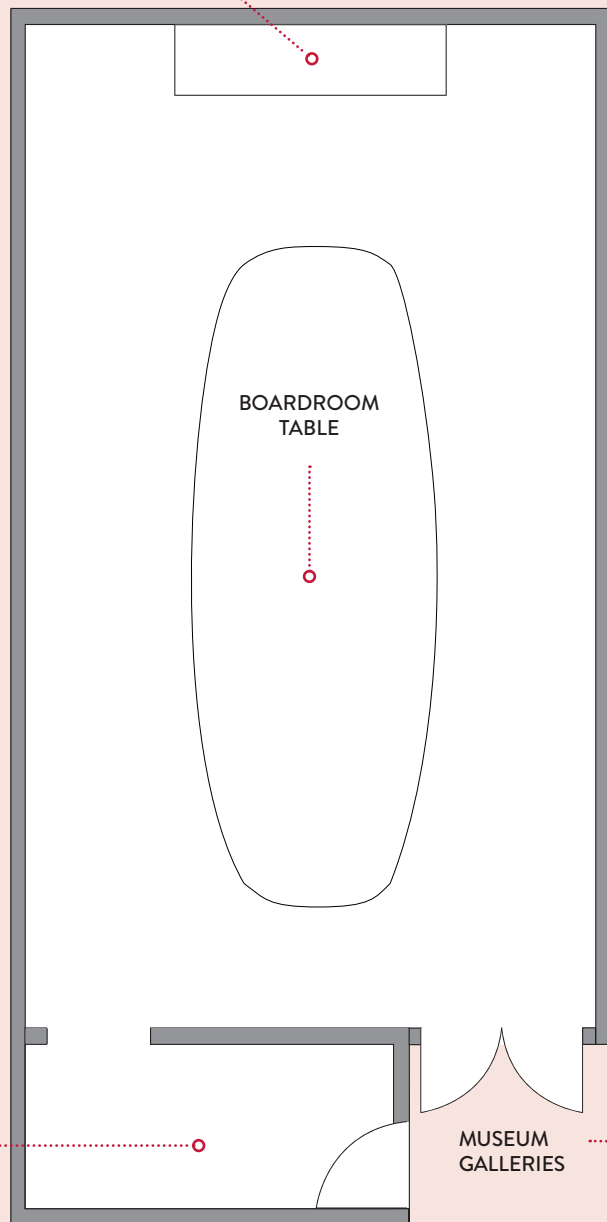

11000

BOARDROOM
TABLE

FREMANTLE
HARBOUR



KITCHENETTE

MUSEUM
GALLERIES